



## Flat 2 Orme Court Granby Road

, Bakewell, DE45 1ES

**£900 PCM**

A two bedroom, second floor apartment centrally located in the heart of Bakewell, benefitting from allocated parking for one vehicle and lift. UNFURNISHED AND AVAILABLE NOW. COUNCIL TAX BAND D

- Two bedroomed apartment in this historic market town
- Second floor with two bay windows
- Generous sitting room
- Dining area
- Galley kitchen
- Shower room
- Allocated parking for one vehicle
- Communal lift in adjoining building
- UNFURNISHED - AVAILABLE NOW
- COUNCIL TAX BAND: D

### Viewing

Please contact our ELR Europa Link Office on 01142689900 if you wish to arrange a viewing appointment for this property or require further information.



2



1



1

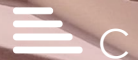

C



Floor Plan

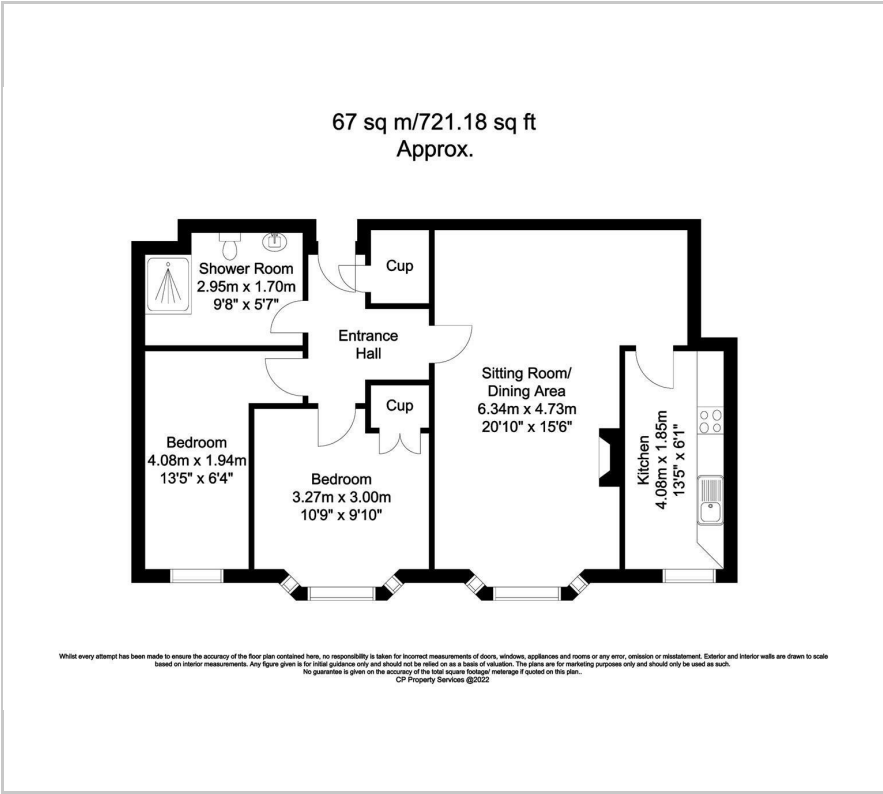

Area Map

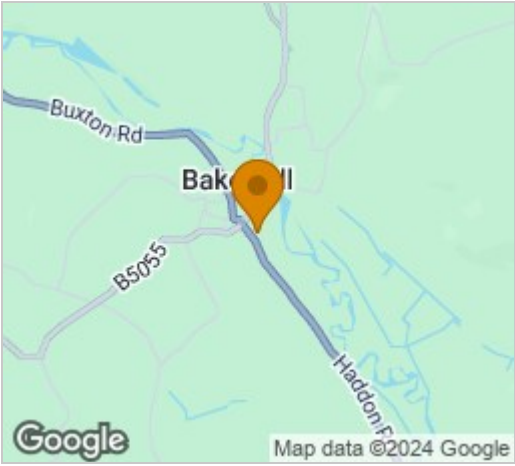

Energy Efficiency Graph

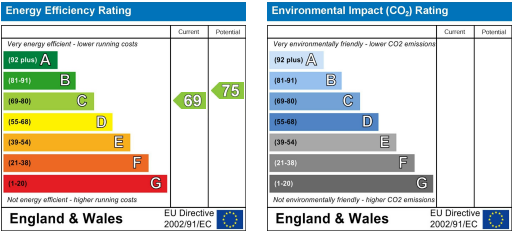

These particulars, whilst believed to be accurate are set out as a general outline only for guidance and do not constitute any part of an offer or contract. Intending purchasers should not rely on them as statements of representation of fact, but must satisfy themselves by inspection or otherwise as to their accuracy. No person in this firms employment has the authority to make or give any representation or warranty in respect of the property.